

▶ Product Features

- Gold plated twin contactor for reliability
- Top tape seal for washing process
- 2, 4, 6, 8, 10 positions
- Low-profile, half-pitch, SMD process
- RoHS compliant

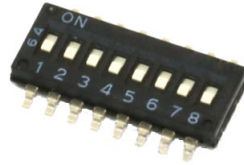

▶ Materials

Cover	Housing	Actuator	Contactor	Terminal	Tape
PPS	PPS	Nylon46	Gold plated phosphor bronze	Gold plated brass	Kapton

▶ Specification

Operating Temperature	-20°C to +85°C
Storage Temperature	-40°C to +85°C
Actuation Life	1,000 cycles
Contact Resistance	100mΩ max.
Position	2, 4, 6, 8, 10
Travel	0.6mm
Insulation Resistance	100MΩ min. at 500VDC
Dielectric Strength	300VAC for 1 min.

▶ Part Number

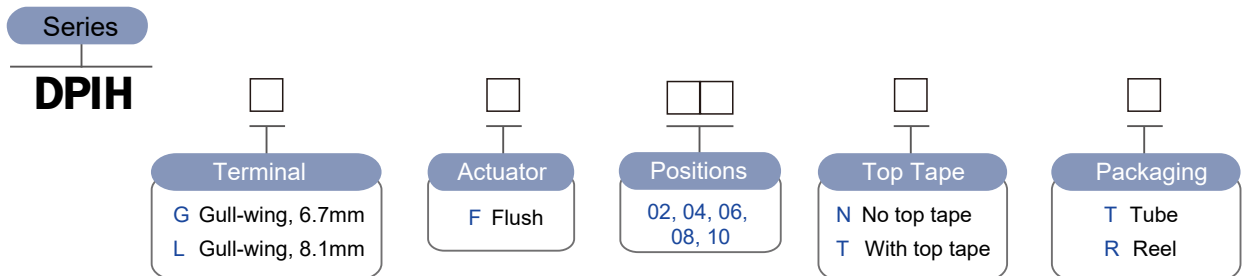

DPIHG Drawing

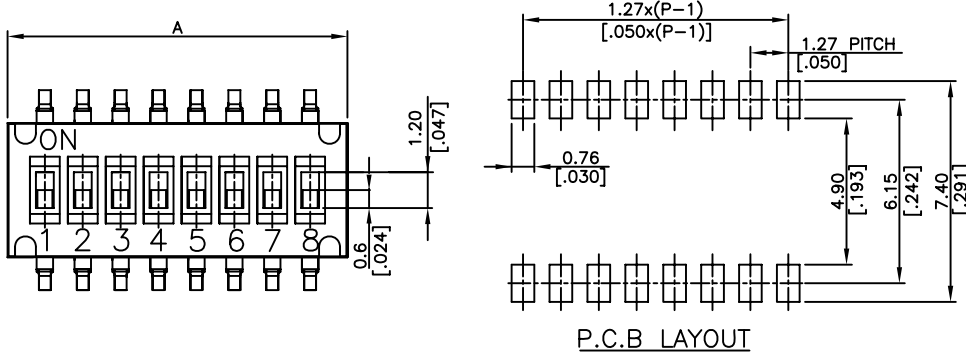

Position	DIM A
02	3.77
04	6.31
06	8.85
08	11.39
10	13.93

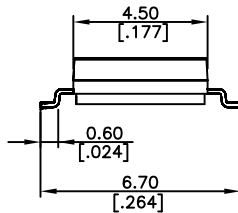
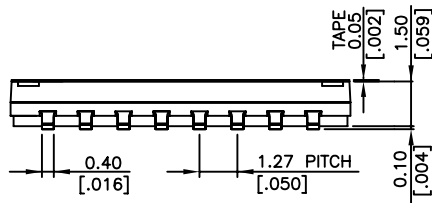

SCHEMATIC(TYP.)



DPIHL Drawing

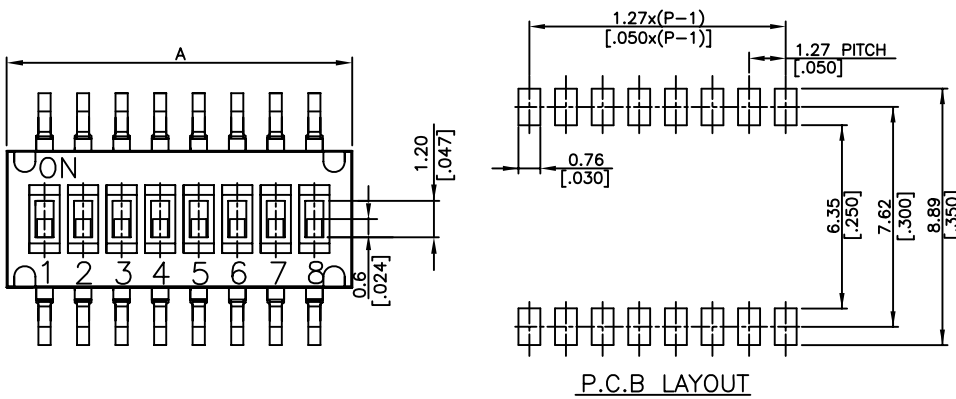

Position	DIM A
02	3.77
04	6.31
06	8.85
08	11.39
10	13.93

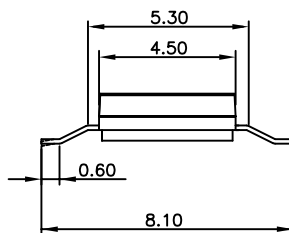
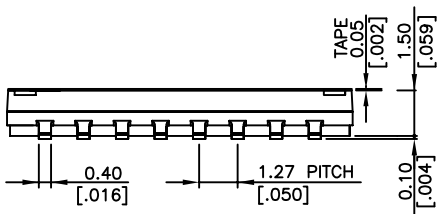

SCHEMATIC(TYP.)

